



# LIONEL

71-2919-250  
1/98

## LIONEL GP9 ELECTROCOUPLERS INSTALLATION KIT

### *Installing your GP9's Electrocouplers™*

Your GP9 is factory-equipped with magnetic couplers. This Electrocoupler™ upgrade kit will allow you to operate your GP9's couplers in the TrainMaster Command environment.

You may wish to have your local authorized Lionel Service Center install your

GP9's Electrocouplers for you, or you may do so yourself by carefully following these instructions.

Remove the GP9's body shell by removing the four screws, (see below) lay the frame and shell on it's left side (cab/front on your right) on a soft protective surface.

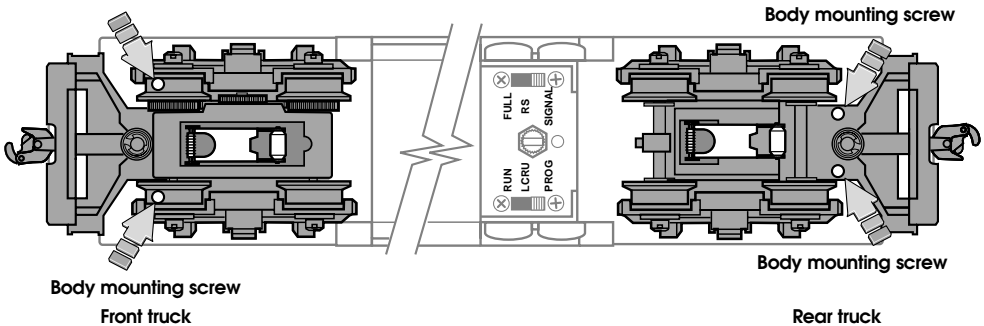

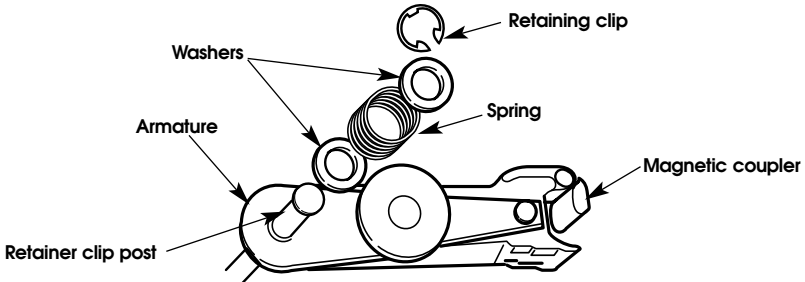

Remove the old magnetic coupler by compressing the washer and spring under the retaining clip, then remove the clip. *Carefully* release pressure on the washer and spring to avoid launching the parts through the air. The retaining post will then drop down and you can remove the old couplers armature. Pull the old coupler through the pilot and you're ready to install your Lionel Electrocoupler (repeat this procedure for the other truck on your GP9)

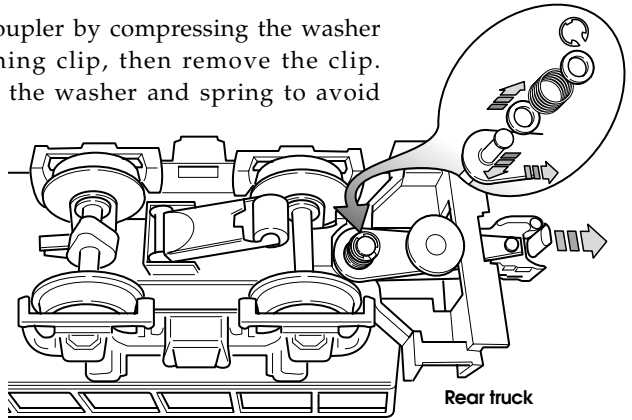

Install the new Electrocoupler by sliding the Electrocoupler and its two wire leads through the pilot and under the mounting boss. Push the retaining clip post up and install a washer then the spring and another washer. Compress the washer and spring, then insert the retaining clip. Be careful when doing this so the parts do not become airborne causing possible eye injury. You are now ready to install the wiring (repeat this procedure for the other truck on your GP9).

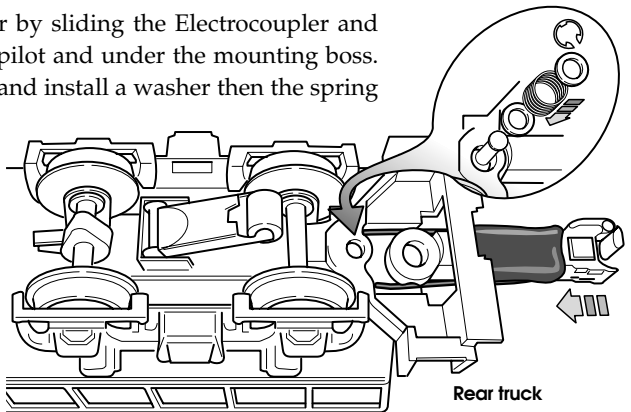

Insert wires through here

Rear truck

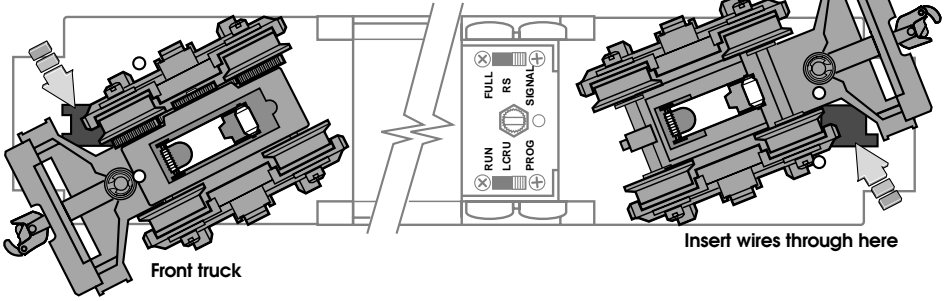

**Note!**

The Railsounds circuit board is a sophisticated electronic device and is extremely sensitive to static electricity. Please avoid ALL contact with the circuit board.

Insert the wires from your Electrocouplers through the holes in the GP9 frame as shown above. Lay your GP9 on it's left side so the cab is on your right. Locate the large bundle of black ground wires held with a wire nut. They should be located towards the cab area of your GP9. Unscrew the wire nut and add the bare wires from both the front and rear Electrocoupler to the bundle and screw on the wire nut. Included in your update kit is a small white female connector, with the front facing you as shown at below, insert the wire lead from the rear coupler with the

snap facing forward, into the left slot of the connector. Now place the wire lead from the front coupler with the snap facing forward, into the right side of the connector. Locate a row of plug in connectors on the LCRU board as shown by the arrow at right. There is an empty two prong male connector that your new female connector will then plug into. *Note* it is important that the rear coupler lead wire be inserted on the left side and the front coupler lead wire be inserted on the right, if they are reversed the command buttons will operate the wrong coupler.

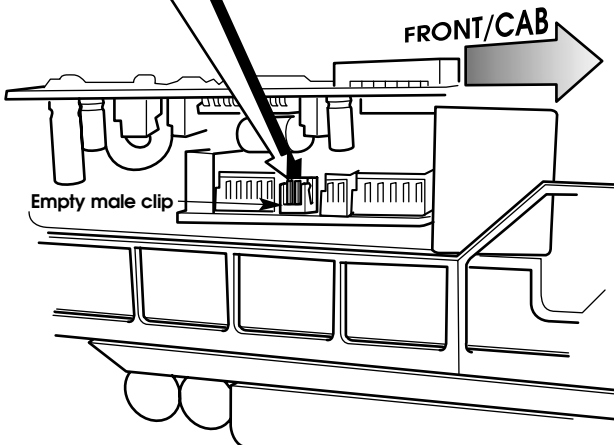
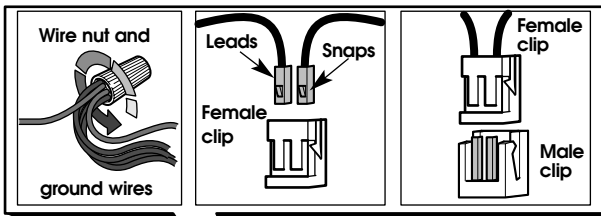

## ***Using your GP-9's Electrocoupler in the non-Command environment***

To use your GP-9's Electrocoupler in the non-Command environment, you must first couple a piece of rolling stock equipped with Lionel magnetic

Magnetic coupler on the rolling stock coupled to your GP-9

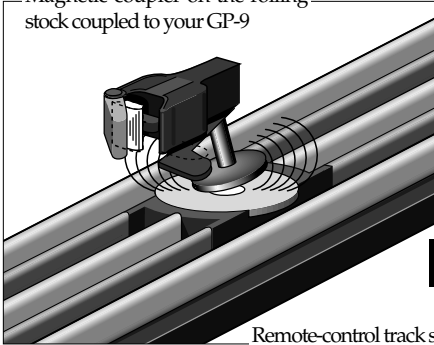

couplers directly to your GP-9. The magnetic coupler on the rolling stock will then react to the magnetic field generated by a Lionel remote-control track section (available separately). Place your rolling stock's coupler "trigger disc" over the central coil of a remote-control track section and press *uncouple* on the controller. The magnetic field pulls the disc downward, and the coupler opens.

### **Note!**

*Your GP-9s Electrocoupler will NOT open manually or by using a remote-control track section*

## ***Using your GP-9's Electrocoupler in the TrainMaster Command environment***

Now your Lionel GP-9 is equipped with front and rear Electrocouplers that respond to the COUPLER F (front) and COUPLER R (rear) button on your CAB-1 remote when operated in the Trainmaster Command envi-

ronment. Simply press either button on your CAB-1 remote, and that coupler opens.



### **Note!**

*Your GP-9's Electrocoupler is NOT designed to be opened manually.*

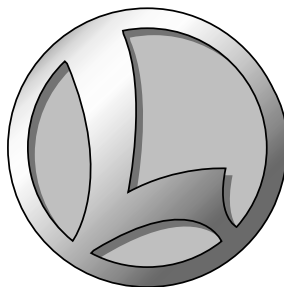

# LIONEL