

72-4134-250
5/02



***Lionel
Gantry Crane
Owner's Manual***

Congratulations!

Congratulations on your purchase of the Lionel Gantry Crane! Use the controller to raise and lower the hoist and bucket, or swivel the cab

360 degrees. This classic accessory is ready to go to work on your layout!

Table of contents

Wiring the Gantry Crane	3
Placing the Gantry Crane on your layout	4
Controlling the Gantry Crane	5-7
Limited Warranty/Lionel Service	8

Caution! Do not touch the hook, eyelet, solenoid or the protective housing. These components reach high temperatures during the course of normal operation. Children must be supervised by an adult when operating this product.

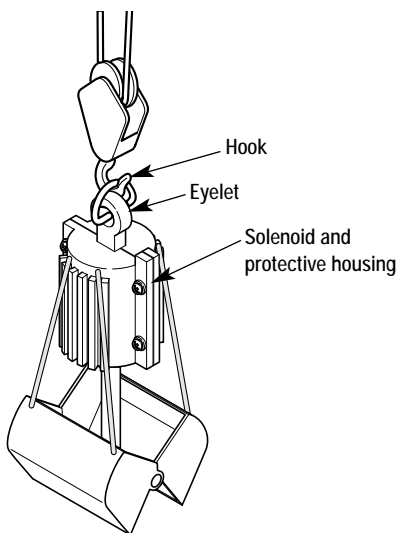

The following Lionel marks may be used throughout this instruction manual and are protected under law. All rights reserved.

Lionel®, *TrainMaster®*, *Odyssey®*, *RailSounds™*, *CrewTalk™*, *TowerCom™*, *DynaChuff™*, *StationSounds™*, *Pullmor®*, *ElectroCoupler™*, *Magne-Traction®*, *CAB-1 Remote Controller®*, *PowerMaster®*, *Lionel ZW®*, *ZW®*, *PowerHouse®*, *TMCC™*

Wiring the Gantry Crane

To wire the Gantry Crane, simply connect the two black wires on the controller to the accessory terminals on your transformer, an accessory power supply, or a Lionel Lock-On (available separately, part no. 6-62900). The Gantry Crane operates best at 12-18 volts (AC). Figure 1 illustrates the wiring of this accessory.

Caution! To make the proper connections, the ends of the wires must be stripped back 1/4" to 3/8". Use a pair of wire strippers or a sharp knife to strip the wires. Only an adult should perform this task! Always use care when stripping wires.

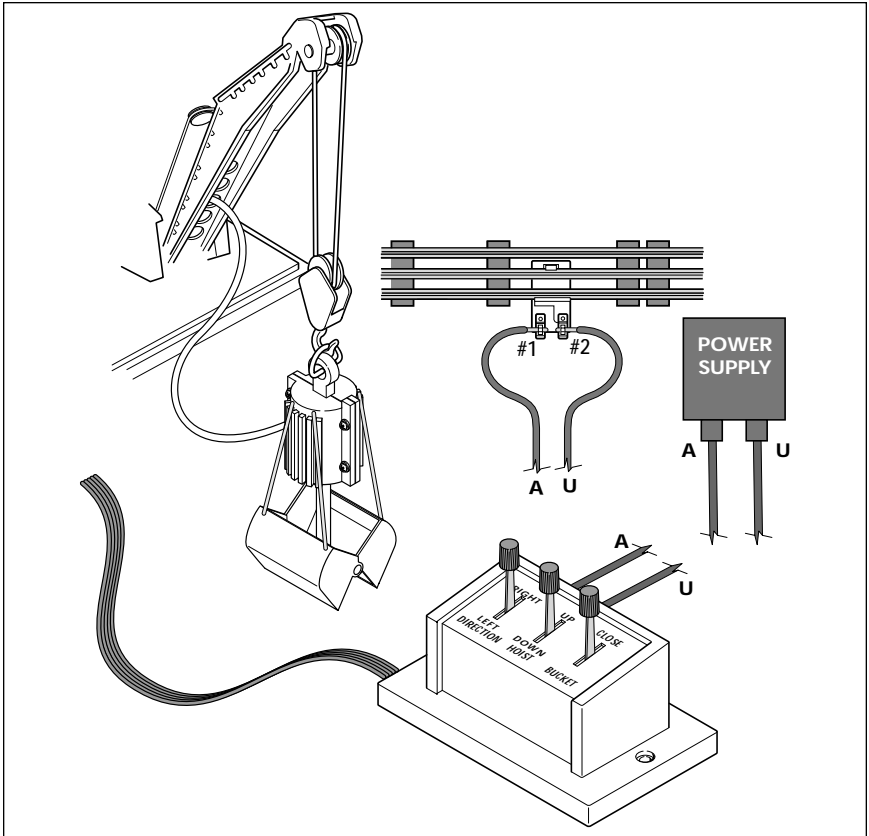

Figure 1. Power connections

Placing the Gantry Crane on your layout

The Gantry Crane is perfect for loading and unloading freight cars. To accomplish this task, you may choose to place the gantry along side of your mainline or near a freight yard. You may also choose to have the gantry straddle the track, allowing you to load and unload the cars that pass below.

Caution! Be sure that your trains are able to clear this accessory.

Also, you may choose to build a track system for the gantry. Two rails spaced at

4 1/2" will allow your gantry to roll into position. Keep in mind that the movement of the gantry is not a motorized function; roll the gantry along the track by hand.

Suspend the bucket from the hook by the ring above the solenoid. Finally, make sure that the string travels through the pulleys and that the bucket control wire is out of the way. See Figure 2.

Caution! Be sure that the solenoid and its housing are cool before touching these components.

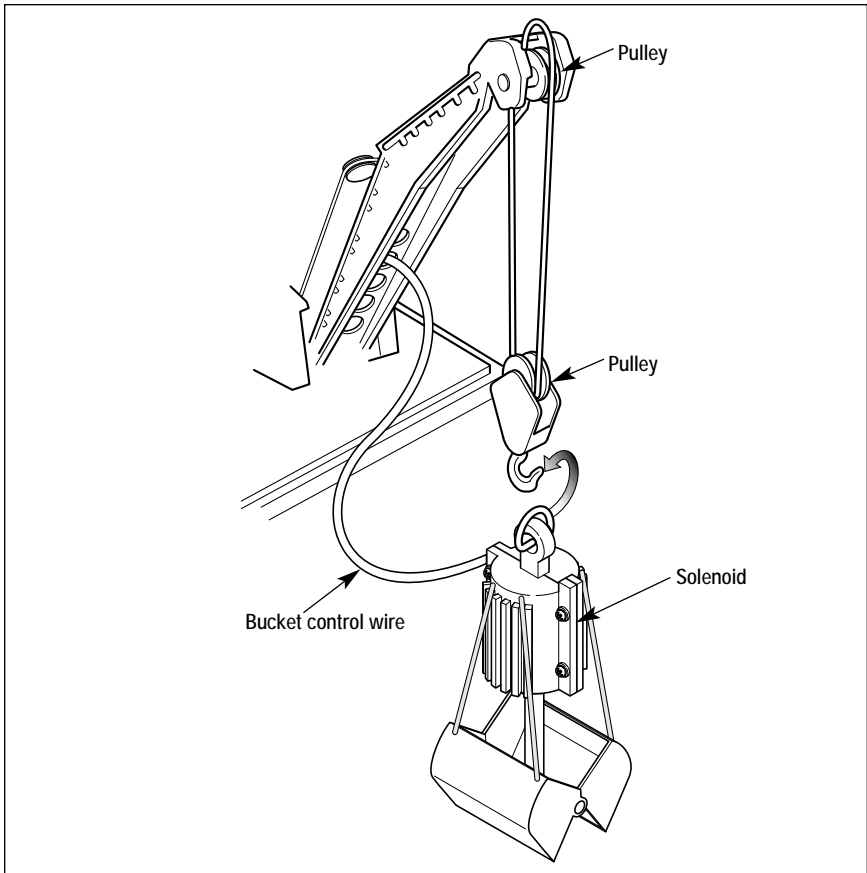

Figure 2. Crane and hanger assembly

Controlling the Gantry Crane

The Gantry Crane has three functions that are operated using a different lever on the controller. The cab and boom rotate clockwise and counter-clockwise (see Figure 3); the hoist and bucket are raised and lowered (see Figure 4); and the bucket is opened and closed (see Figure 5). The controller shown in each Figure illustrates the lever that controls the function. Use the controller to perform any combination of these operations as you load and unload your freight cars. Also, turn the wheel at the back of the cab to raise and lower the boom as illustrated in Figure 6.

Note! You will find that the hoist and bucket are raised and lowered when you rotate the cab. The crane cannot rotate when the

hoist reaches the boom; for additional rotation, lower the hoist to free the bind.

Note! If you attempt to continue the downward motion of the hook past its lowest point, the string will unwind to its full length and then begin to rewind on its spool in the opposite direction. This will reverse the HOIST lever UP and DOWN designation on the controller. Should this happen, simply set the HOIST lever to the UP position and allow the string to completely unwind (lowering the hoist) and begin to wind up in the opposite direction.

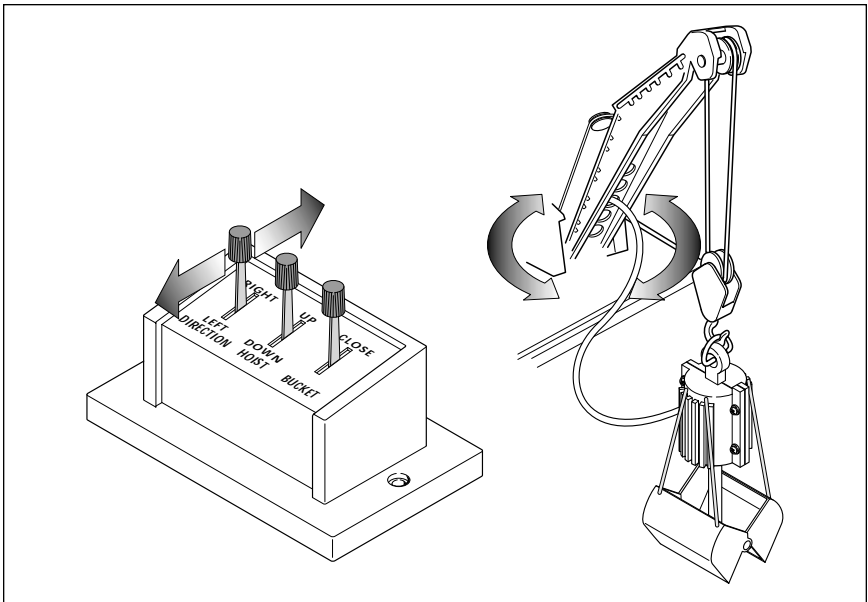

Figure 3. Crane direction

Controlling the Gantry Crane (continued)

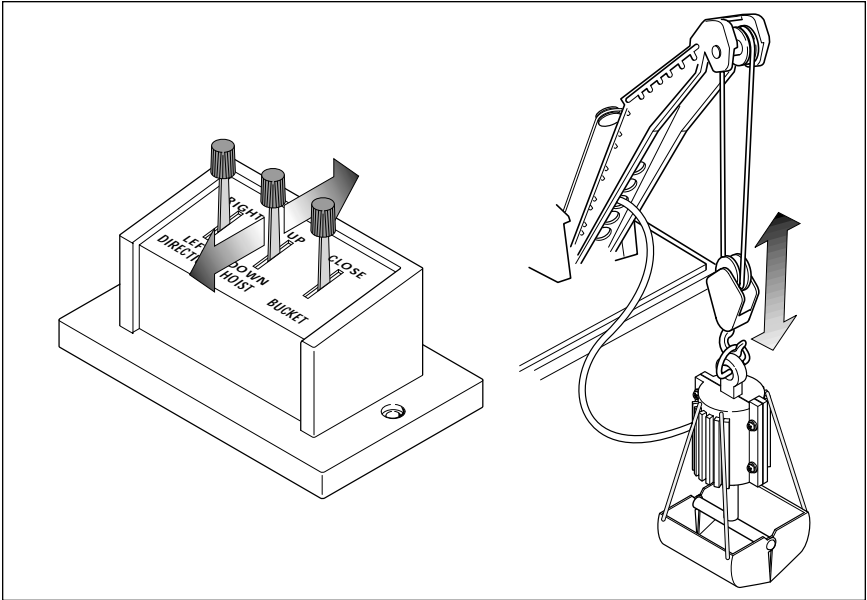

Figure 4. Bucket up and down

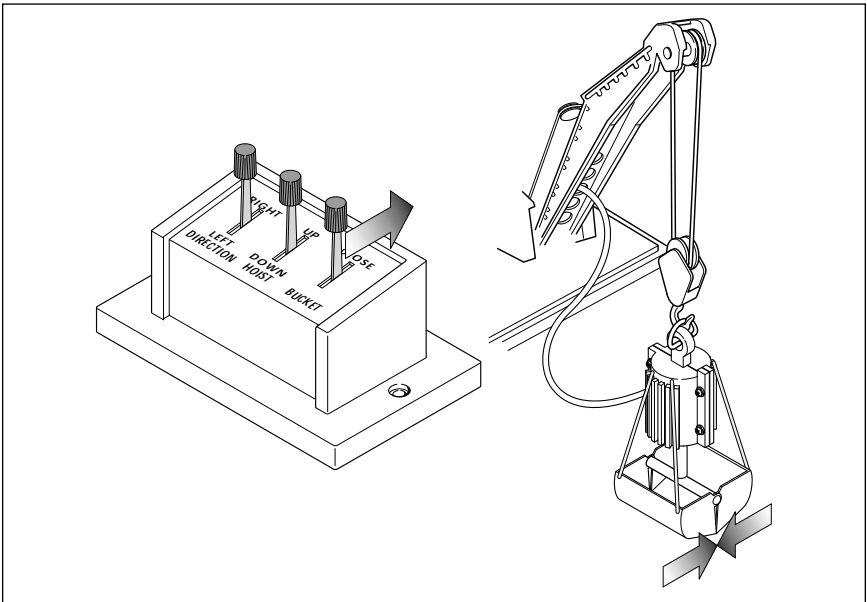

Figure 5. Bucket closed

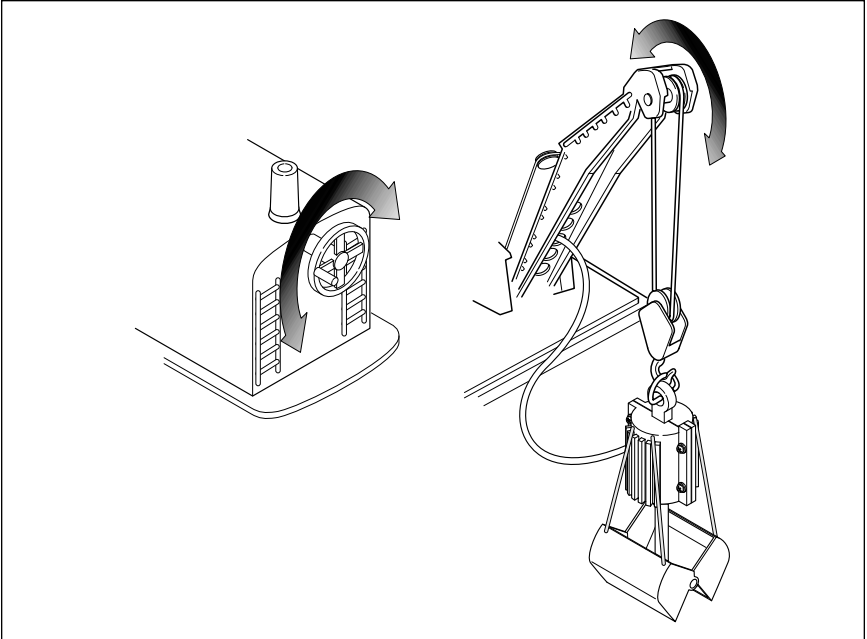

Figure 6. Boom up and down

Limited Warranty/Lionel Service

This Lionel product, including all mechanical and electrical components, moving parts, motors and structural components, except for light bulbs, is warranted to the original consumer-purchaser, for **one year** against original defects in materials or workmanship when purchased through an authorized Lionel merchant.

This warranty does NOT cover normal wear and tear, light bulbs, defects appearing in the course of commercial use, or damage resulting from abuse or misuse of the product by the purchaser. Transfer of this product by the original consumer-purchaser to another person voids this warranty. Modification of this product voids this warranty.

Any warranted product which is defective in original materials or workmanship and is delivered by the original consumer-purchaser to Lionel L.L.C. or an authorized Lionel L.L.C. Service Center, together with proof of original purchase will, at the option of Lionel L.L.C., be repaired or replaced, without charge for parts or labor. In the event the defective product cannot be repaired, and a replacement is not available, a refund of the original purchase price will be granted. Any products on which warranty service is sought must be sent freight or postage prepaid, as transportation and shipping charges are not covered by the warranty.

In no event shall Lionel L.L.C. be liable for incidental or consequential damages.

Some states do not allow the exclusion or limitation of incidental or consequential damages, so the above exclusion may not apply to you.

This limited warranty gives you specific legal rights, and you may have other rights which vary from state to state.

Instructions for Obtaining Service

If service for this Lionel L.L.C. product is required, bring the item, along with your dated sales receipt and completed warranty information

to the nearest Authorized Lionel Service Center. Your nearest Lionel Service Center can be found by calling 1-800-4-Lionel, or by accessing our Website at www.lionel.com.

If you prefer to send your product back to Lionel L.L.C. for repair in Michigan, you must first call 586-949-4100 or FAX 586-949-5429, or write to Customer Service, P.O. Box 748, New Baltimore, MI 48047-0748, stating what the item is, when it was purchased and what seems to be the problem. You will be sent a return authorization letter and label to ensure your merchandise will be properly handled upon receipt.

Once you have received your return authorization and label, make sure that the item is packed to prevent damage during shipping and handling. We suggest that you use the product's original packaging. This shipment must be prepaid and we recommend that it be insured.

Please make sure you have followed all of the above instructions carefully before returning any merchandise for service. You may choose to have your product repaired by one of our Authorized Lionel Service Centers after its warranty has expired. A reasonable service fee will be charged.

Warranty Information

Please complete the information below and keep it, along with your dated sales receipt. You must present this and your dated sales receipt when requesting warranty service.

Name _____

Address _____

Place of Purchase _____

Date of Purchase _____

Product Number _____

Product Description _____

